

1

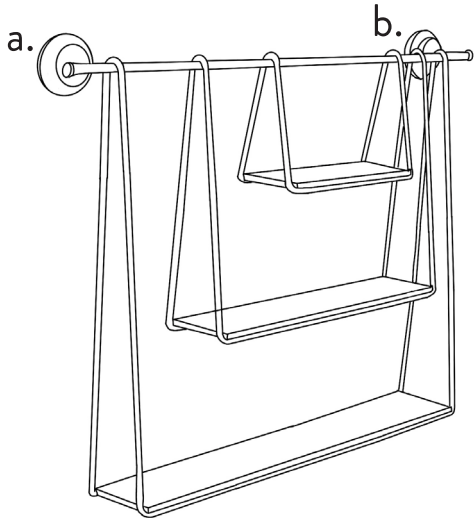

(A) & (B) HAVE KEY HOLES on the back.

2

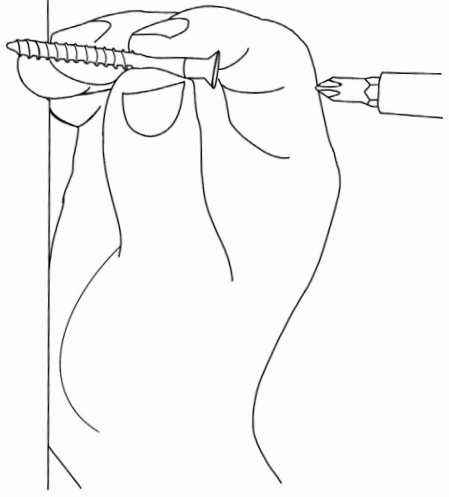

DRILL (2) SCREWS, evenly spaced apart, into the wall leaving the head of the screws sticking out slightly.

3

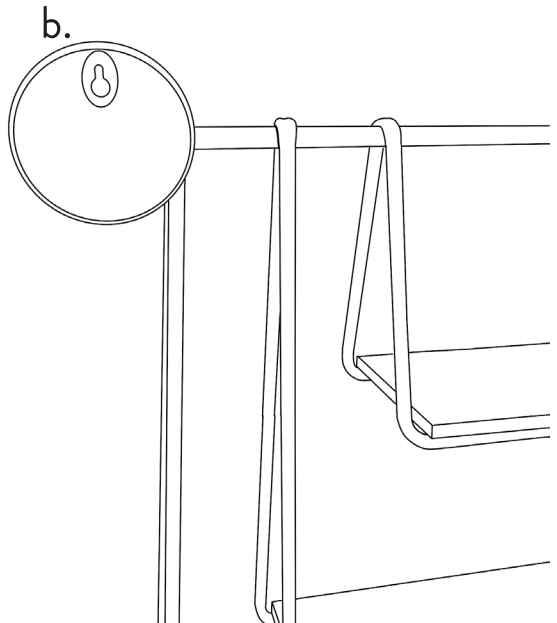

LINE (A) & (B)'S KEYHOLES UP with the screws. Push shelf onto the screws so that the shelf is flush with the wall.

4

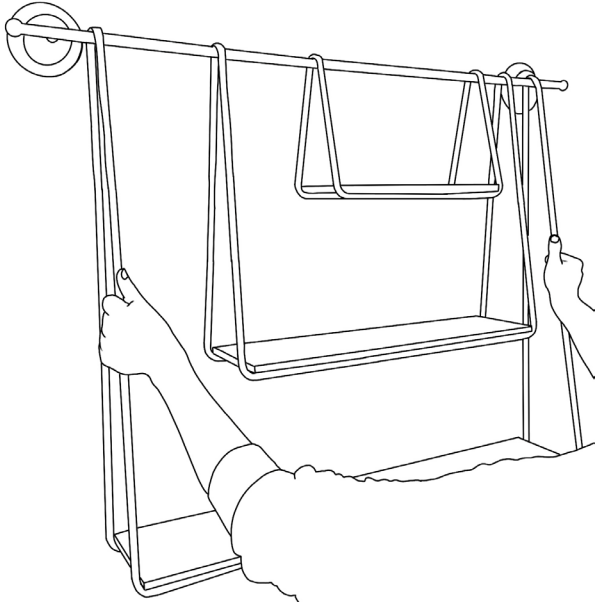

CAREFULLY PULL SHELF down so the screw heads slip into the narrow part of the keyholes, thus locking the shelf in place.